

Infrared WC control system INEO BRIGHT, battery

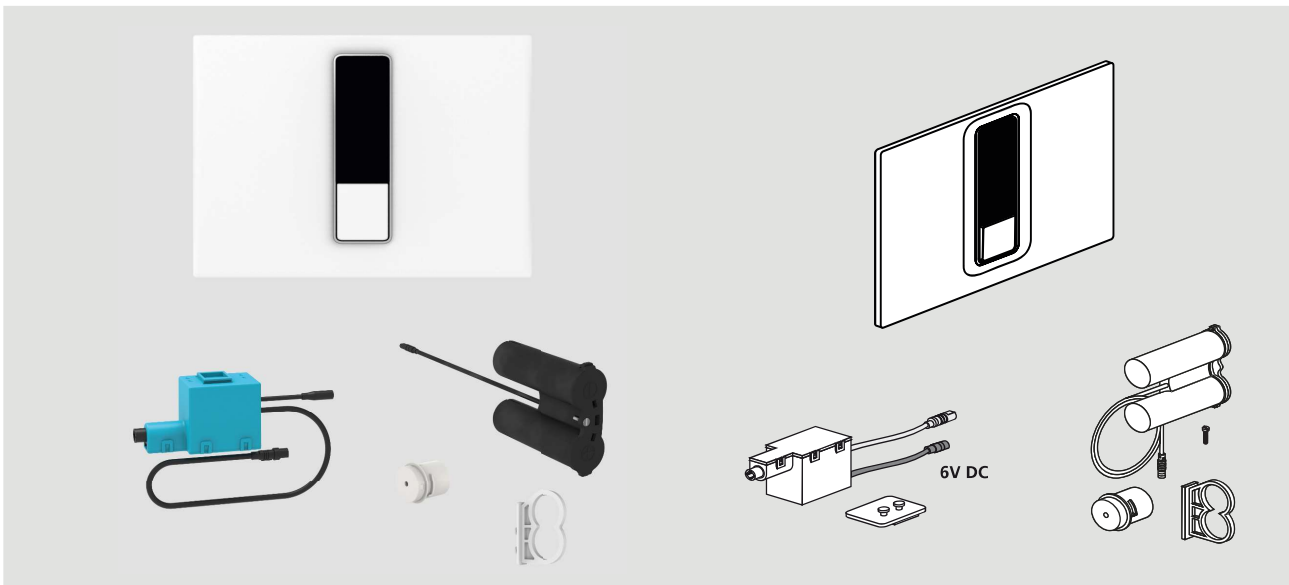

Usage

- forr SANIT for concealed cisterns with small access opening
- for use in private and semi-public areas

Features

- touch-free infrared sensor controlled WC dual flush system
- dual flush, front operated
- user identification via light bar in the sensor field
- automatic flush release by user detection or contact-free by hand
- additional option for manual flush release via push plate

Technical specifications

- l/w/h: 202/145/10 mm
- long sensor range approx. 800 mm
- short sensor range approx. 60 mm
- power supply via 4 alkaline batteries 1.5V R14 (to be ordered separately)
- defined flush volumes adjustable via flush valve INEO
- flush release: automatic, touch free or manual
- flush interval freely selectable, factory set to 24 h
- light colour for user detection selectable: red/green/blue

Included

- actuator + IR module, incl. chromed decorative frame
- cover and fixing bolts
- low-noise low-voltage motor as lifting device and control electronics
- voltage input: with cable and plug for unequivocal installation
- voltage output: cable and encoded plug for unequivocal installation to power supply
- with bracket for low-voltage motor

Infrared WC control system INEO BRIGHT, battery

Code no.

- 16.759.01..0000 - plastic, alpine white
- 16.762.01..0000 - thermosetting plastic, white
- 16.759.00..0000 - brushed stainless steel
- 16.759.81..0000 - plastic, chrome

Accessories

- service and maintenance remote control Code No. 03.806.00..0000

Note:

For the concealed cisterns CC-120-S, CC-150-S and CC-200-S a motor bracket Code No. 05.339.00..0000 and a universal flush valve INEO Code No. 03.982.00..0000 is required prior to series stand 20.